

AQ 240A/280



V-8, 4-stroke carburetor engine with model 280B outboard drive

STANDARD EQUIPMENT

ENGINE BODY – Cylinder block and heads made of special cast iron. Light-alloy pistons with 2 compression rings and one oil scraper ring. Crankshaft journalled in 5 bearings. Overhead valves with hydraulic valve lifters and self-rotating exhaust valves.

FUEL SYSTEM – Four-barrel carburetor with automatic choke (6). Fuel pump (8) driven from camshaft.

COOLING SYSTEM – Thermostat-controlled seawater cooling system. Sea-water pump (3) with neoprene rubber impeller and circulation pump for effective cooling.

LUBRICATING SYSTEM – Pressure-lubricating system with full-flow lubricating oil filter of the spin-on type (12). Sealed crankcase ventilation.

INTAKE SYSTEM – Flame arrester of U.S.C.G. approved type (7).

EXHAUST SYSTEM – Sea-water cooled exhaust manifolds made of cast iron with high risers (5). Complete exhaust line for connection to the outboard drive.

ELECTRICAL SYSTEM – Corrosionsproof 12 V electrical system. Pre-wired eight way standard plug fastened to the engine. Operating switch and control light for power lift complete with 7 m (23 ft) cable harness with plug-in contact. Automatic fuse of the reset type mounted on engine. Alternator with built-on transistorized regulator, 38 A, 450 W (11). Starter motor output 960 W (1.3 h.p.) (13).

FRONT ENGINE MOUNTING – Adjustable front rubber mounting (9).

OUTBOARD DRIVE – Complete with mounting collar, rubber-suspended flywheel housing and installation parts. All gears are of the helical cut bevel type, designed for continuous operation in either direction of rotation. Cone clutch (patented) of Silent Shift type provides reliable operation and quiet engagement with small manoeuvring forces. The drive can be tilted up 60°.

The shift mechanism has an easily adjustable link rod for altering the propeller direction of rotation from left-hand to right-hand.

Steering arm (2) with connection for steering cable. Two self sacrificing zink anodes protects the outboard drive against corrosion (1). Cooling water intake at front and bottom of drive for cooling water supply to engine (10).

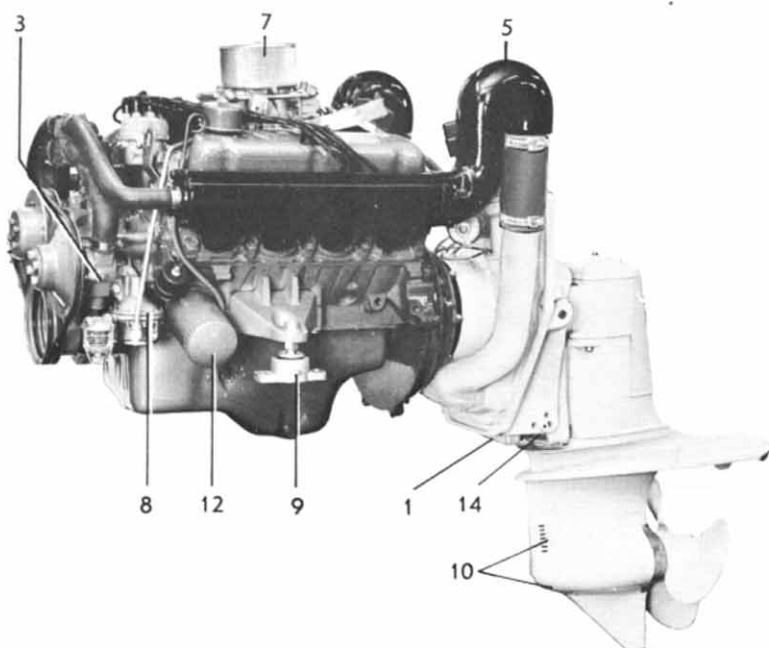
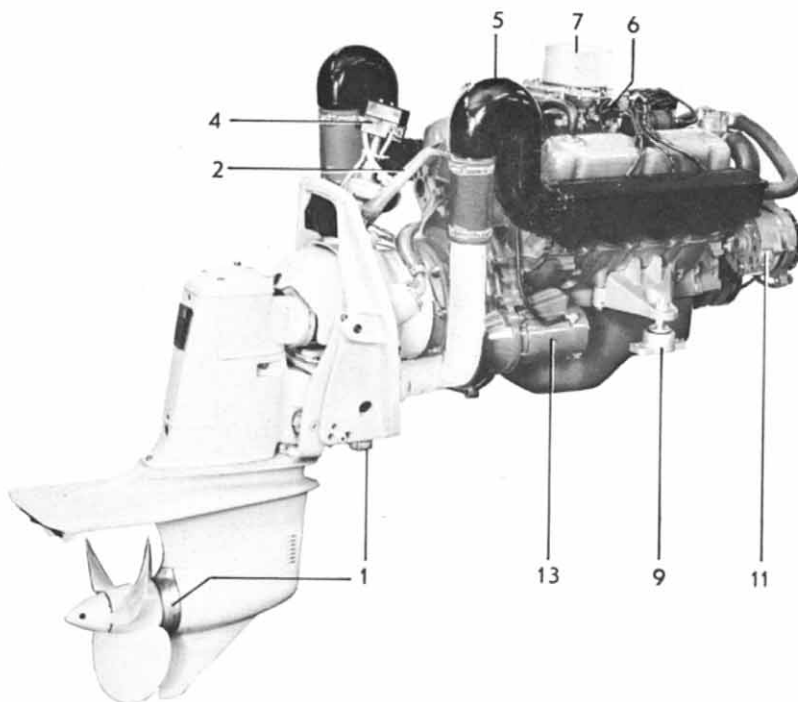

Reversing pawl (14) of patented design permits the drive to kick up when striking underwater objects. Yet holding the drive in downward position when going in reverse or pulling back the throttle rapidly in forward motion.

Electro-mechanical power tilt (4) with completely plastic embedded electrical system.

EXTRA EQUIPMENT

FUEL SYSTEM

Water-separating filter with or without flexible hoses.
Fuel line kit with copper piping and installation parts.
Electrically operated fuel pump

COOLING SYSTEM

Extra cooling water intake for fitting on transom.

ELECTRICAL SYSTEM AND INSTRUMENT

Electric-hourmeter



Master switch
Cable harness extension
Tool kit

OUTBOARD DRIVE

Extensions for outboard drive

BOAT ACCESSORIES

Electrically operated bilge pump
Original paint
Oils
Electro-mechanical trim tabs

Instrument panel, which is extra equipment, is provided with key switch, rev counter, temperature gauge, oil pressure gauge, Volt meter and switch for instrument lighting.

CONTROLS AND CONTROL SYSTEM

VP single-control lever for both speed and forward-reverse operation, top-mounted or side-mounted. Single or twin installation.

Safety switch
Control cables
Steering gears
Steering wheel
Steering cables
Ball joint for steering cable
Tie-bar kit for twin installation
Clamp block for steering cable.
Support tube for steering cable.
Bracket for steering cable compl.
Steering linkage kit for installation on upper transom. shield bolts.
Hydraulic steering system

AQUAMATIC PROPELLERS

DATA

Type of operation . . . 4-stroke carburetor engine with hydraulic overhead valves
Designation AQ240A/280B
Max. output¹⁾ 231 hp (170 kW)
Max. operating speed, r/s (rpm) 70.0 (4200)
Number of cylinders V8
Capacity, dm³ (in³) 5.765 (351)
Bore/Stroke, mm (in) 101.6/88.9 (4.00/3.50)
Compression ratio 8.1:1
Carburetor One 4-barrel with aut. choke
Fuel quality leaded fuel min. 93 octane
Outboard drive, type design. and red. 280B/1.61:1
Total weight, kg (lb), approx. 410 (905)

1) Max. flywheel output acc. to DIN 6270 leistung B

DIMENSION DRAWING

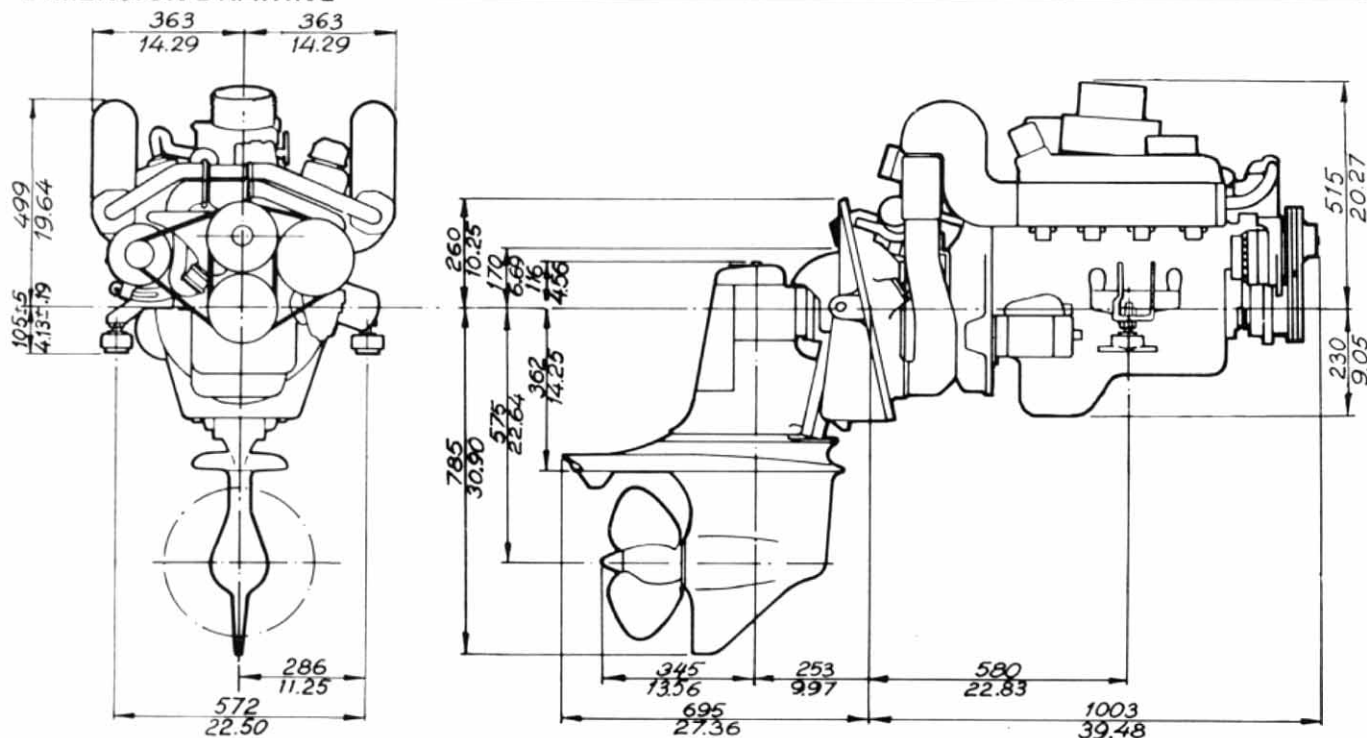

VOLVO PENTA

We reserve the right to carry out modifications

S-405 08 Göteborg, Sweden
Telephone: 031/23 54 60
Cables: Penta Göteborg
Telex: 207 55 PENTA S